



BENCHWORK

P.O. Box 100
986 Jackson Harbor Road
Washington Island, WI 54246

(920) 847-2264
mail@sieversbenchwork.com
www.sieversbenchwork.com

Assembly Guide

Tools Required:

- Phillips-head screwdriver or power screwdriver
- 7/16" wrench
- Hammer (for tapping T-nuts into Leg bottoms)
- Optional: Wood Sealer (If benchwork will be located in an area of high humidity)

Hardware Included:

Sections, Large and (Small):

- 20 (12) - 1 3/4 inch #10 Flat-Head woodscrews
- 3 (2) - 1/4 x 2" Carriage Bolts, washers, and nuts (for connecting one section to another)

Leg Assemblies:

- 4 - 1 3/4 inch #10 Flat-Head woodscrews
- 2 - 1/4 x 1 1/2" Carriage Bolts, washers, and nuts
- 2 - Leg Levelers and T-nuts

Risers and L-Girders:

- 1 1/4" #10 Flat-Head woodscrews

Angle Sections:

- 1/4 x 2" Carriage Bolts, washers, and nuts (for attachment)

Using the packing list enclosed, unpack and sort all wooden pieces and hardware before beginning assembly.

Sections:

Side Rails have countersunk holes to attach Cross Braces and 1/4" holes for bolting on legs, additional sections, or angles.

Cross Braces have 3/4" holes for wire or cables, 1/4" holes for bolting sections together, and pilot holes at each end for connecting Side Rails.

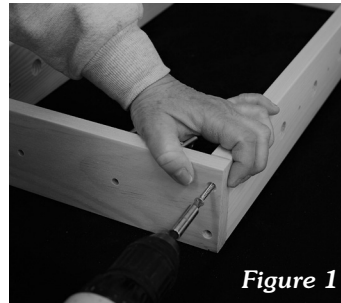

Figure 1

Step 1 - Screw Cross Brace to Side Rail. (See Fig. 1) The Sievers Benchwork stamp will face the inside of the section. **NOTE:** A blue pencil line indicates the top edge of each piece.

Step 2 - Repeat for each Cross Brace until your section is complete. (See Fig. 2) The template diagrams on the other side of this sheet will show you how many pieces are used in each section.



Figure 2

If a Section becomes twisted (not square) after assembly, just loosen the screws, adjust pieces, and re-tighten.

Leg Assemblies:

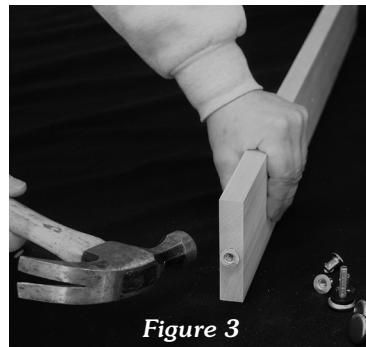

Figure 3

Step 3 - Insert T-nut into the predrilled holes at the bottom of each leg by hammering until it is flush with the wood. (See Fig. 3)

Step 4 - Thread the leg leveler into the T-nut. (The leg leveler adds an additional 7/16" - 1" to the total leg height.)

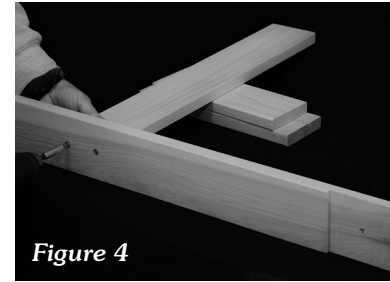

Figure 4

Step 5 - With the dadoes facing out, fasten the Leg Brace between the two legs. (See Fig. 4)

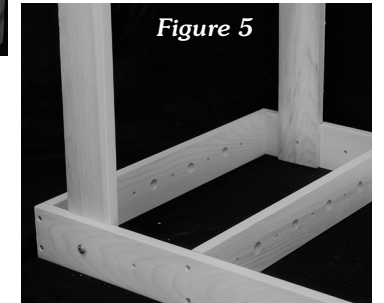

Figure 5

Step 6 - Bolt the Leg Assemblies to the sections. (See Fig. 5) We recommend spacing Leg Assemblies approx. every 3 feet to insure a solid base for your roadbed.

If you sandwich a leg between two Sections, you will need to purchase longer carriage bolts (1/4" x 2 1/2" or 3").

Angle Sections, Risers, and L-Girders:



Step 7 - Once your layout is fully assembled you can attach Angle Sections, Risers, and L-Girders.

Angle Sections have 1/4" holes for bolting to sections.

Risers and L-Girders have countersunk holes and can be attached to any part of the benchwork. You will have to predrill pilot holes for the 1 1/4" screws.

If you choose to change your layout, simply loosen the bolts that connect the sections together and rearrange to your liking.

Finish your tabletop using 1/2" - 3/4" plywood.

Thank you for choosing Sievers Benchwork!

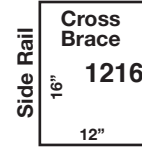
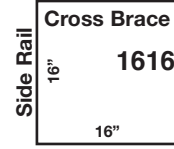
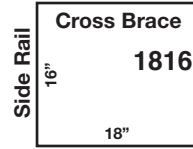
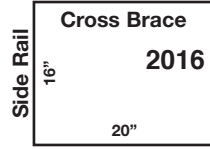
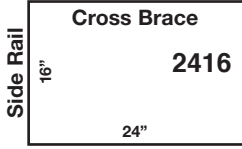
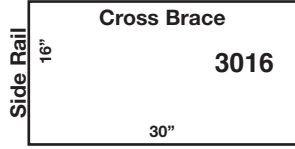
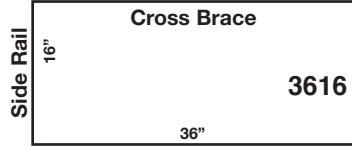
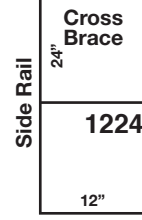
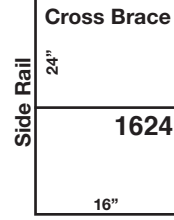
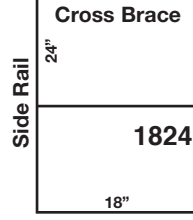
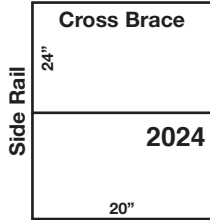
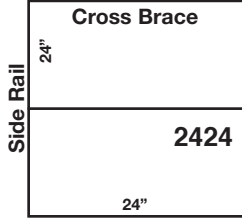
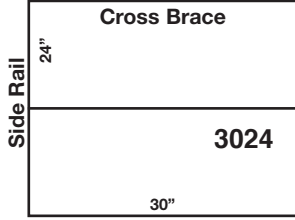
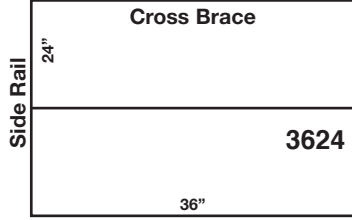
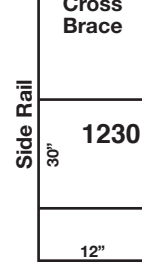
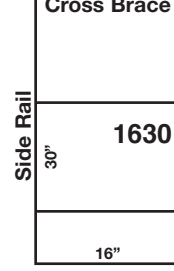
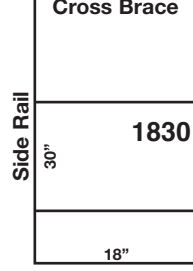
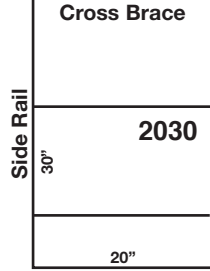
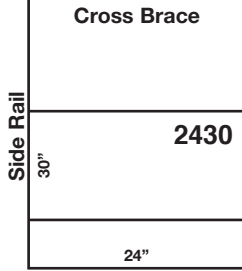
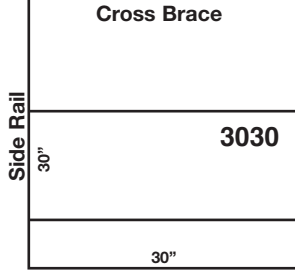
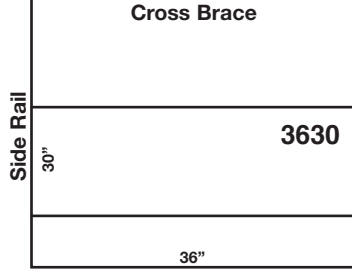
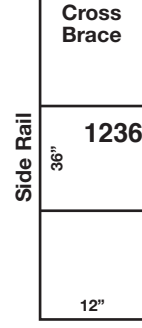
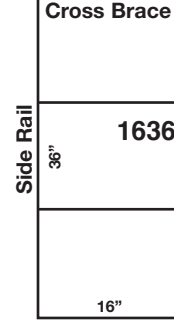
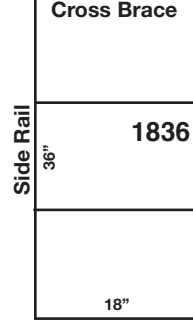
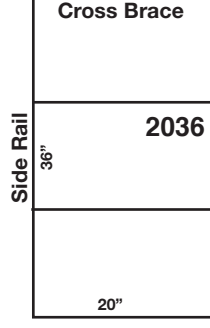
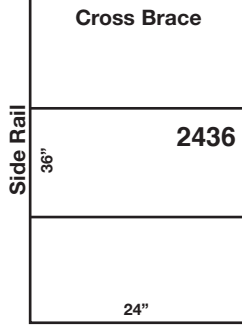
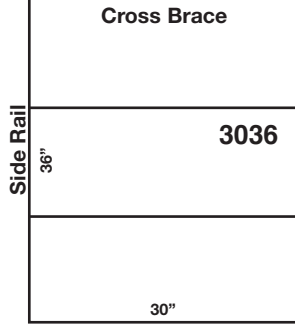
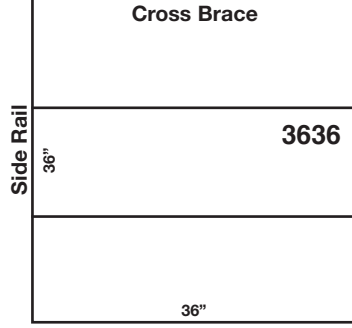
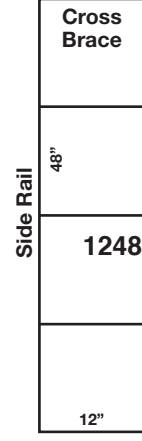
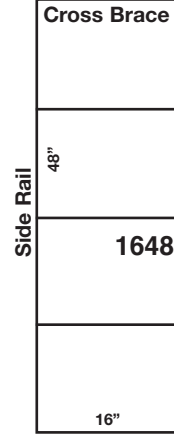
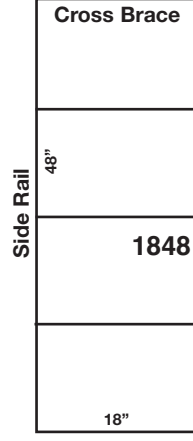
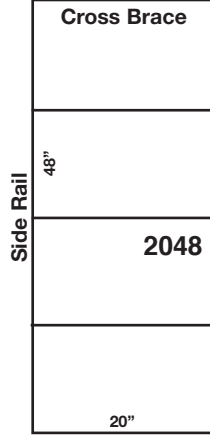
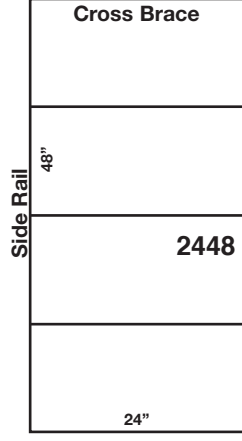
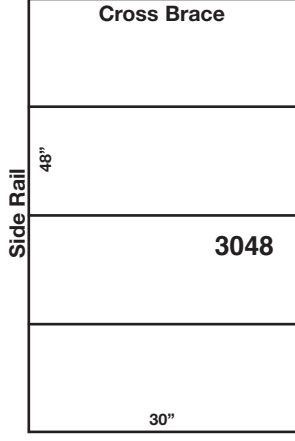
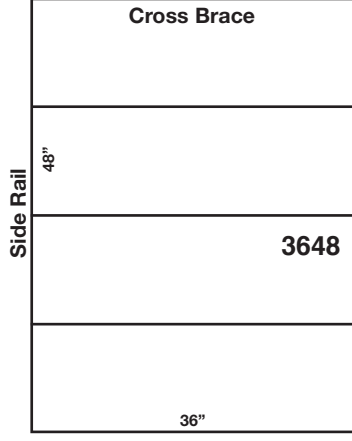

45° and 30° ANGLE SECTIONS

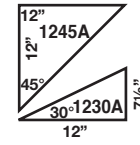
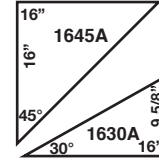
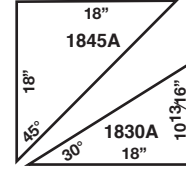
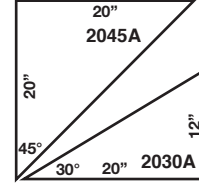
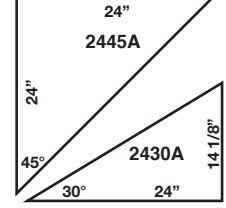
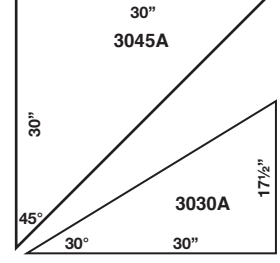

45° and 30° ANGLE SECTIONS

45° and 30° ANGLE SECTIONS



BENCHWORK
P. O. Box 100
986 Jackson Harbor Road

(920) 847-2264
Washington Island, WI 54246

www.sieversbenchwork.com
mail@sieversbenchwork.com

45° and 30° ANGLE SECTIONS